



EXER-FLY

ULTIMATE INSTRUCTION MANUAL



ONLINE
DOWNLOAD

V.1.2



Contents

Specifications	3
Dimensions	3
Weight	3
Overview of parts	3
Accessories	3
Safety	4
Safety - Using the motor	5
Introduction	6
Overview	6
Flywheels	6
Features	7
Eccentric loading	7
Range of exercises	7
Ergonomics	7
Noise reduction	7
Safety features	8
Continuous motion	8
Self-managed resistance	8
Reduced risk of injury	8
Constant tension	8
Recovery from injuries	9
Physio & rehab	10
Adaptive resistance	10
Injury Prevention	10
Space efficiency	10
Rehabilitation after injury	10
Product overview	11
Platform	11
Rope clamp	12
Control panel	12
How to use the equipment	13
Foot placement	13
Attach the rope clamp	13
Selecting flywheels	14
Workout zones	14
Using the squat harness	15
Arm & shoulder workouts	16
Recording stats & metrics	16

Contents

Other movements	17
Control panel	18
Menu options	19
Attaching the wheels	20
Attaching the extension	21
Enabling/disabling motor	22
Device holder	23
Attaching the device holder	23
Accessories	24
Squat harness	24
Curl bar	24
Foot block	24
Rope guide	25
Bench	25
T-Bar	25
Additional accessories	26
Troubleshooting	27
Maintenance	28
Bearings	28
Rope/webbing	28
Rope clamp	28
Warranty	29
Exceptions	29
Support	29
Transportation	29
Limitations of liability	29
Statement of compliance	30

Specifications

Dimensions

Top: 1170 mm x 770 mm (46" x 30")
Height: 310 mm (12")

Weight

20kg (excl accessories and flywheels)

Overview of parts:

- 7075 Aluminium shaft
- 3mm powder coated aluminum
- High quality bearings
- Large flywheel (0.1 kg.m2) 5kg
- Medium flywheel (0.05 kg.m2) 3.5kg
- Small flywheel (0.025 kg.m2) 2.5kg
- XSmall flywheel (0.0125 kg.m2) 1.8kg
- Max flywheels: 10 or 1.0 kg.m2
- Rope clamp
- Nylon & dyneema rope
- Rotational sensor
- Non-slip surface
- Wheels

Accessories

- Squat harness
- Squat belt
- Ankle cuff
- Flywheel holder
- Flywheel bag
- Rope guide
- Bench press
- Foot block
- Short bar
- Curl bar
- Tricep rope
- Stirrup handle
- Device holder
- Extension
- Sensor & app

Safety

The output of flywheel training depends on how much energy you put into it, so if you don't move it very quickly then it won't give you much back. In many ways it's self limiting but you should always exercise at an intensity you can manage.

If you haven't done a lot of activity then you may feel quite sore for a few days afterwards as your muscles will not be used to the constant resistance.

- 1 Keep away from the spinning flywheel and other moving parts when you or someone is using it.
- 2 Start with low inertial flywheels to learn how your body moves through the range of motion with the flywheel.
- 3 If you feel pain or dizziness during exercise, stop immediately. Likewise, be mindful when fatigue hits as this can affect balance and uncontrolled body movements. If you have problems with balance make sure someone can support you, or hold on to another fixed object like a wall or broomstick.
- 4 Keep children and pets away from the machine when in use.
- 5 Always place the equipment on a solid, flat surface.
- 6 Don't stop an exercise in the top position.
- 7 Don't let the rope clamp hit the equipment, make sure you absorb the load before it hits the equipment.
- 8 Make sure the flywheel stops fully before finishing using the equipment.
- 9 Always have both feet on the Exerfly Ultimate when using, unless the equipment is fixed to the ground.



Safety - Using the motor

- 1 Read the Sensor & App Instructions.
- 2 Using the Eccentric boost amplifies the energy of the flywheel in the eccentric phase. Improper use could cause significant injury. Make sure you've had ample warm up and conditioning before attempting to use the motor boost. If this is your first time using the motor boost, always start with a low Eccentric Overload Boost % (eg, 1 - 5%) to get the feeling of what you can handle.
- 3 Small flywheels can spin very quickly, so it's actually safer to use large flywheels to start with because they spin more slowly.. Begin with a 1.0 kg.m² inertia (large) flywheel at 1 - 5% overload.
- 4 The use of the motor overload is not suitable for people with injuries, unfit, unconditioned or elderly people. The Exerfly Ultimate is still able to be used without using the motor.
- 5 The Exerfly Ultimate uses an automatic wind-in mechanism to get started when using the motor boost.
- 6 After 5 minutes of inactivity, the motor boost will default to 0%. You can easily increase this back to your desired level in the app, or via the control panel.

Introduction

Overview

The Exerfly Ultimate flywheel training equipment is a stable and capable piece of strength training equipment built for everything from heavy-duty workouts to rehabilitation. The Exerfly Ultimate allows users to perform a vast range of exercises in a small footprint, and caters to a wide range of users from elite athletes and teams, to intermediate users wanting to build on their health and fitness, and can also assist in rehabilitation.

Using your muscles, you accelerate and decelerate flywheels on the Exerfly equipment to stimulate your muscles and nervous system, resulting in increased strength and muscle activation over time.

Flywheels

The flywheels are available in four sizes - extra small, small, medium and large. Small flywheels are easier to move and spin faster, whereas large flywheels are harder to move and spin slower but have more energy and momentum and are more difficult to stop. You can stack the flywheels to make your workouts more difficult as you progress.

If you are first starting out with flywheel training, then start with smaller flywheels while you become familiar with the movements. Although, larger muscles like the leg muscles can handle extra resistance with larger flywheels.

Mounting and removing flywheels is easy, just unscrew the end cap and slot a flywheel on to the shaft. Then screw the end cap on.

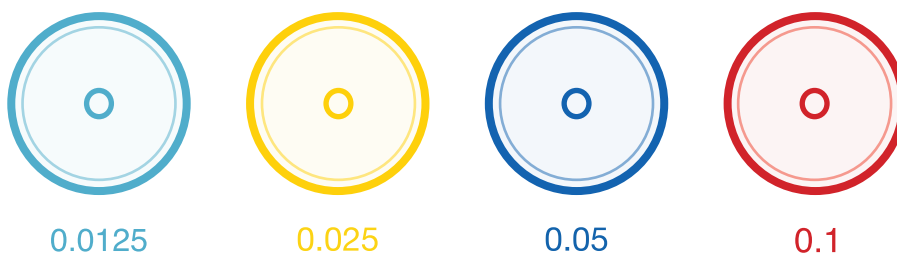

Features



Eccentric loading

Your muscles are about 40% stronger in the eccentric phase (sometimes called negative phase) of a movement. This is when your muscles are undergoing lengthening. It's difficult to train your muscles eccentrically with traditional gym equipment because the weights always weigh the same and people tend to let the weights drop with gravity. Often a 2nd person is required to add force to the eccentric movement.

The benefits of eccentric training are well understood, and the Exerfly equipment makes it easy to train your muscles eccentrically. If you can speed up the movement in the concentric phase of a movement, you'll produce a lot of energy in the flywheel, and decelerate in a shorter amount of time, then you'll experience an eccentric overload.

Eccentric overload training is very beneficial but also very fatiguing, so you will likely exhibit muscle soreness over a few days if you are not used to it. This is called delayed onset muscle soreness (DOMS).



Range of exercises

The Exerfly Ultimate allows a huge range of exercises at different intensities. Because the resistance is variable, based on how many flywheels you use and how hard you pull, you can get a range of muscle stimulus to suit professional athletes and teams, or more pedestrian movements and rehab.



Ergonomics

The Exerfly Squat Harness gives users the confidence to approach squats with ease. The Exerfly Squat Harness spreads the load across the shoulders and lower back so it's much more comfortable to use than a traditional squat bar and perfect for people who find squats difficult due to back problems. The squat belt is an even better choice for people who have back problems as it only loads the hips when doing squat exercises.



Noise reduction

Usage of the Exerfly Ultimate is virtually silent, so it's also perfect for home or office use. Additionally, there's no need to constantly change weights, or risk dropping weights and making a lot of noise. Some users may find the flywheels make a noise when changing direction, to remedy this make sure the end cap is tightened.

Safety features



At Exerfly, we believe that prevention is key. That's why we've engineered a product with a strong focus on safety and injury prevention that maximizes effort and results.



Continuous motion

Flywheel training provides a constant, smooth resistance for muscles throughout the entire range of movement of an exercise. The motion of pulling a flywheel is incredibly fluid and smooth, with no snap between the concentric and eccentric phases of motion, meaning less risk of injury to the athlete.



Self-managed resistance

Users are able to manage their own resistance load in a safe range of motion and determine their own force output, meaning the resistance is based directly on the expended effort of the athlete. This allows the athlete to warm up at their own pace, then slowly increase their effort while the machine adapts to their movements, as opposed to conventional weight training with static loads unable to adapt and respond to the athlete's needs.



Reduced risk of injury

A recent study of flywheel training shows that adding a weekly eccentric overload squat training to a regular basketball and volleyball exercise routine enhanced lower limb muscle power without triggering patellar tendon complaints. Another study also showed that football players participating in eccentric overload training just 1-2 times a week were significantly lower risk for hamstring injuries.



Constant tension

The constant tension and emphasis in the eccentric phase of the exercise adapts muscles for power and speed, and helps reduce the likelihood injury. Exerfly mimics natural sports movements, meaning the athlete is less likely to injure themselves both on and off the machine.

Safety features



Recovery from injuries

Exerfly's carefully engineered design makes it the perfect tool for recovery. Whether recovering from surgery, when atrophy and loss of muscle strength occurs rapidly, in early rehabilitation and strength training, or in late-stage rehabilitation of musculoskeletal injuries, Flywheel training addresses both strength and power and can be used in most stages of rehabilitation.

Studies show that Eccentric training for injured tendons leads to a reduction in pain, decreased stiffness in the tendon, increased neovascularization, enhanced neuroplasticity, and increased shielding of muscles.

Physio and rehab



Adaptive resistance for recovery

With Exerfly flywheel training, resistance is based on the inertia of the flywheel and the input force of the athlete's expended effort. This means the machine adapts to the needs and capabilities of the individual athlete, whether that be intense, intermediate, or recovery. As a reactive and responsive piece of equipment, Exerfly offers a better form of recovery than static, conventional weights that do not adapt to the individual's performance. It allows the athlete to ease into the exercise at their own pace, lessening or challenging the resistance as needed.



Preserve joint health and prevent injury

Lower body eccentric training using the Exerfly can be performed with a harness. This reduces injury risk by distributing the load evenly across the shoulders and lower back throughout the movement, reducing strain commonly experienced by the lower back in exercises such as weighted squats.



Space efficient

The compact size of the Exerfly also means it is ideal for office or home use, eliminating the need for gyms or large training spaces in the workplace. It is portable and easily maneuverable, fitting neatly into small office spaces without compromising on value.



Rehabilitation after injury

Because of its low-impact nature, Exerfly training can effectively aid rehabilitation after injury. A crucial part of Anterior Cruciate Ligament (ACL) rehabilitation focuses on knee control and landing form, which is best rebuilt through eccentric training. By applying resistance throughout the entire range of movement, the muscle gains strength through this entire range as well, allowing for more force without the heavyweight and stress. For upper body injuries, for example arm injuries, attachments such as the squat harness can be attached so the athlete is not totally restricted by their inability to hold heavy weights.

Product overview

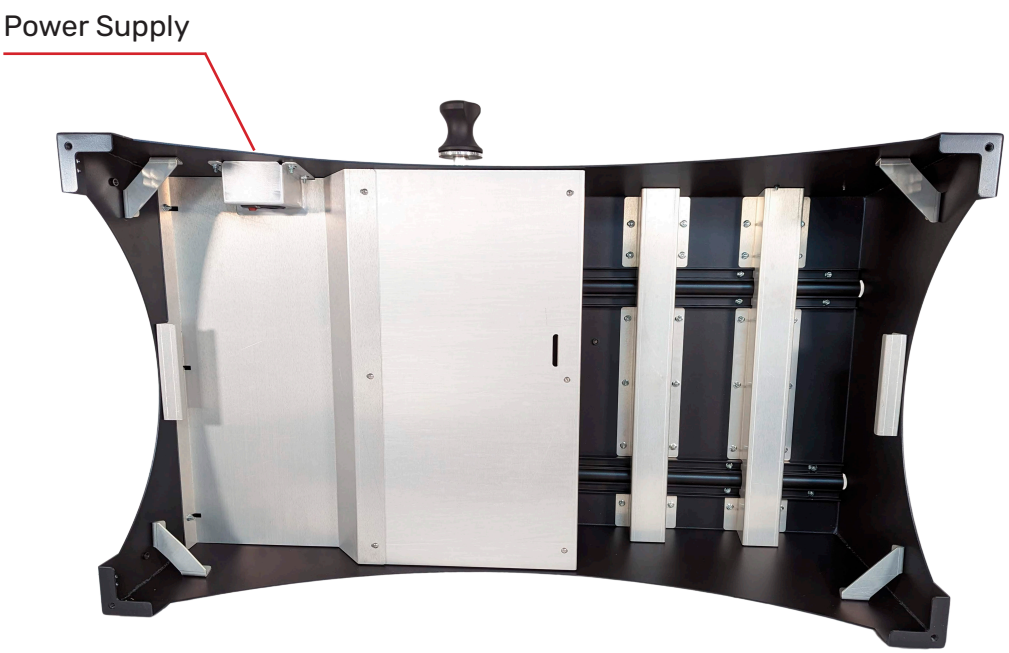
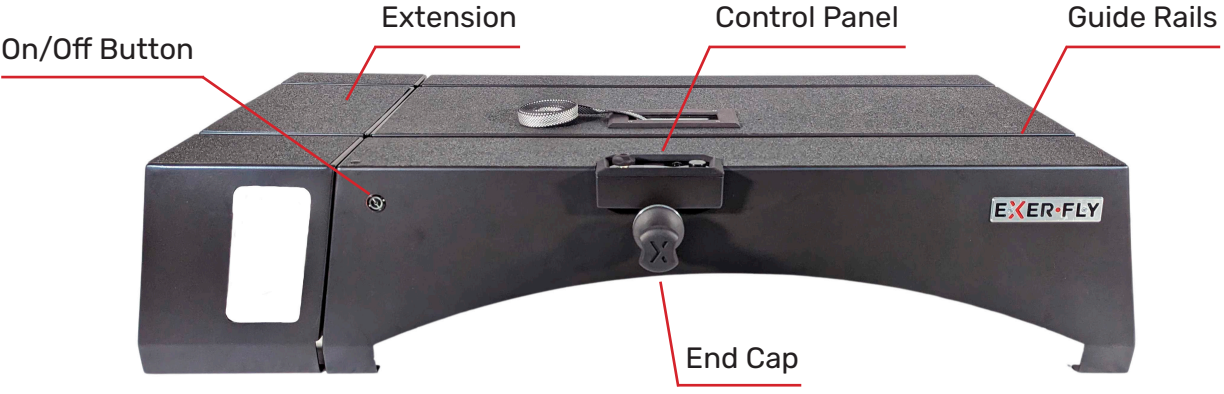

Product overview

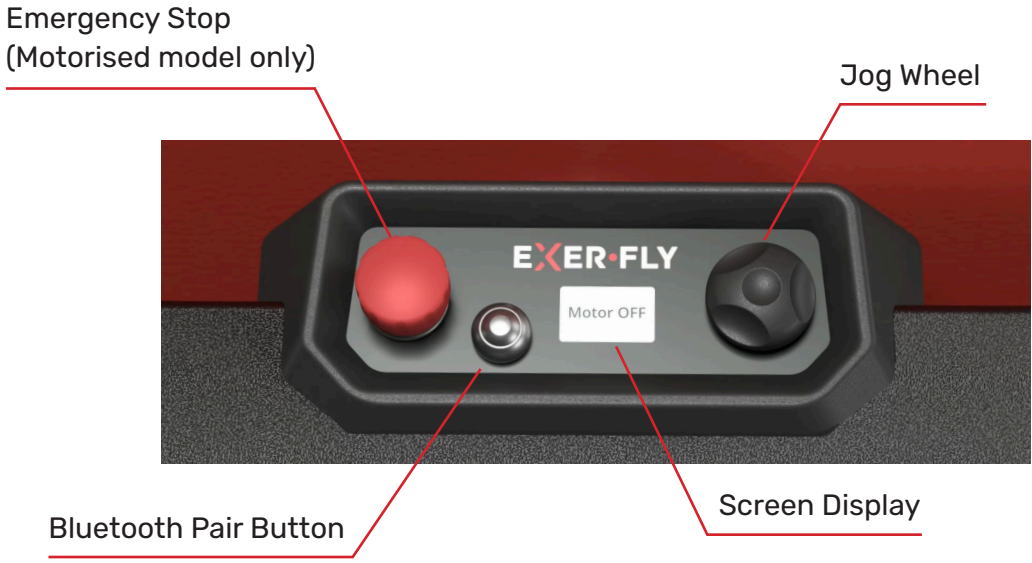

How to use your Exerfly equipment

Now that you have assembled your Exerfly equipment, you need to learn how to use it properly. If at any time you have questions or are unsure about how to use the equipment please book an appointment to talk to a specialist.



Calendly Support

<https://calendly.com/exerfly-support/15min>

SCAN ME

IMPORTANT!

One of the fundamental ideas around flywheel training is to use your muscles to absorb the force in the downward or winding in phase of a movement. Therefore, make sure you absorb the force when the rope is being wound in so that the rope clamp doesn't hit the Exerfly equipment as this can cause damage to the device.

Foot placement

Feet will be placed differently according to which exercise you are doing. If one foot is placed on the ground depending on the exercise, then the Ultimate should be weighed down by weights, someone else standing on it or attached to the floor with the ground attachment kit.

Attach the rope clamp

The rope clamp attaches to the squat harness, squat belt, hand grips, bars and most other gym accessories. Make sure the shackle on top of the rope clamp is properly closed when using the equipment. The rope clamp tightens when it's under tension and you use your hands to release it and move it to a different position on the rope.

Rope Clamp
How-To Video



SCAN ME

How to use your Exerfly equipment

Selecting flywheels

Each flywheel has a different inertia value. The larger flywheels have higher inertia and take more muscular force to spin and build momentum and again require more muscular force to stop. Smaller flywheels have lower inertia and spin faster.

With the Exerfly equipment you can combine flywheels to give you more inertia, up to a maximum of 10 red flywheels.

As a rule of thumb:

- Small flywheels with inertia of 0.0125 are useful for light rehab movements.
- Medium flywheels are good for starting out and for arm exercises.
- Large flywheels are good for lower body exercises. Very strong people find 4 large flywheels challenging in the squats.

To begin with, select a medium flywheel and get used to the movement and feel as it's slightly different to traditional equipment due to the constant force. For more information see the Workout Zones section below.

Workout zones

For beginners or users trying new exercises, you should use small-medium sized flywheels and low intensity to adjust to the feeling of the exercise. It's easier to correct technique at lower speeds and intensity with smaller flywheels, and then increase the flywheel inertia and intensity.

Follow these as guides for working out to get the most out of your exercise regime.

Warm up **Low to medium inertia with low intensity**

Improving technique **Medium inertia with low intensity**

Power **Low inertia with max intensity**

Strength **High inertia with medium/high intensity**

Eccentric overload **See 'Other movements' below**

Isometric **See 'Other movements' below**

How to use your Exerfly equipment

Using the squat harness

Make sure the harness fits well and is not too loose. The shoulder pads should not slip down.

- 1 Tighten the horizontal straps with each buckle on the front.
- 2 Attach the rope clamp shackle to the two D-rings at the bottom of the harness.
- 3 Adjust the rope clamp along the rope to reach a desired height so that the rope becomes tight at the top of an exercise.

Beginners/rehab:

The top position of an exercise should be just before all your active body joints are fully extended.

Experienced users:

Depending on your focus, there can be some slack in the top position but be aware that there may be a jolt when the movement switches to going down. Most users prefer to have time under tension and keep the rope tight at the top of the exercise.

Slightly bend your knees and start to spin the flywheel left or right with your hand or foot so it winds in the rope so you're at the lower point of a squat. Next, accelerate the flywheel by starting to move upwards in the exercise. Keep moving with the exercise up and down and go with the movement of the flywheel to avoid any rests inbetween.

You should reach your desired training intensity after 2-4 reps of spinning the flywheel, and complete 6-12 reps in your set according to your training methods.

To stop the flywheel, decelerate the flywheel by slowing down your movement and stopping at the bottom of the movement. Slowly return to the start position and make sure the flywheel stops completely. Detach the rope clamp from the harness, step off the equipment and have a rest before the next exercise.

Squat Harness
Example Video



How to use your Exerfly equipment

Arm and shoulder workouts

- 1 Attach the rope clamp shackle to the stirrup handle or bar.
- 2 Adjust the rope clamp along the rope to reach a desired height so that the rope becomes tight at the top of an exercise.
- 3 Start to spin the flywheel left or right with your hand or foot so it winds in the rope so your arm(s) are at the lower point of the exercise. Next, accelerate the flywheel by starting to move your arms in the exercise. Keep moving with the exercise up and down and go with the movement of the flywheel to avoid any rests in between. You should reach your desired training intensity after 2-4 reps of spinning the flywheel, and complete 6-12 reps in your set according to your training methods.

To stop the flywheel, decelerate the flywheel by slowing down your movement and stopping at the bottom of the movement. Slowly return to the start position and make sure the flywheel stops completely. Detach the rope clamp if necessary, step off the equipment and have a rest before the next exercise.

Exercise
Example Video



Recording workout stats/metrics

If your Exerfly equipment features a sensor, you can get workout statistics for each rep and exercise to display on a mobile device or computer so you can track your progress over time. Please see the Ultimate Sensor Manual to connect the sensor to your device.

How to use your Exerfly equipment

Other movements

One of the benefits of using Exerfly Equipment is that the range of exercises you can do is almost unlimited. Additionally, you can achieve other techniques such as isometric exercises and eccentric overload.

Isometric - Used to maintain strength. The muscle doesn't move much in these exercises. Use a partner to hold the flywheel from moving while you exert maximum pull on the rope.

Exercise
Example Video



Eccentric overload - In the eccentric phase of a movement, your muscles are up to 40% stronger so being able to overload your muscles in this phase can bring benefits to your strength and rehab that are difficult or impossible to achieve with traditional equipment. Use a partner or your legs to assist in speeding up the concentric phase of a movement so the corresponding eccentric phase is overloaded.

Exercise
Example Video



How to use your Exerfly equipment

Control panel

If your Exerfly Ultimate came with the motorized technology, you can select how much eccentric overload to include in your reps.

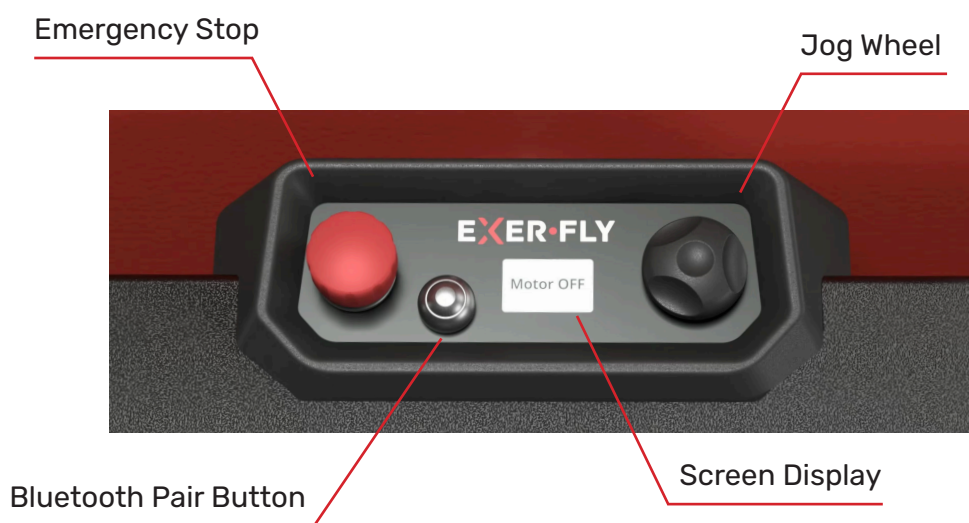

Jog wheel

Use the jog wheel to scroll through the menu items and push to select an item.

Bluetooth pair button

Push the black button to pair with Bluetooth, or reset the unit so it disconnects a user and allows another user to connect to Bluetooth.

Emergency stop button

Press to cut the motor. A light on the button stays on when the button is pressed down.

Note: Once the button is pressed, it stays pressed down and the motor will not work until you twist the button to release it. If the motor does not function, check if the stop button is pressed down.

Equipment menu options

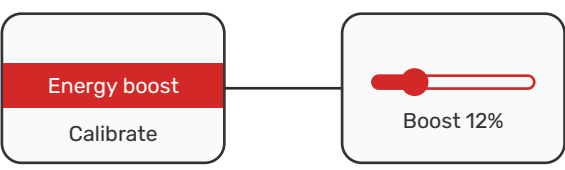

Energy Boost

Adjust the energy boost of the motor output in the eccentric phase. After 5 minutes of inactivity, the motor boost will set to 0% boost.

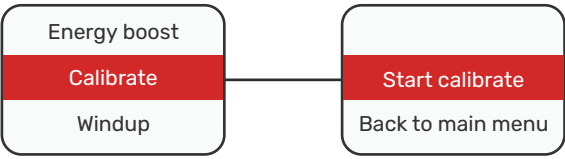

Calibrate

When holding the rope out straight, click the calibrate option to set the zero angle of the shaft so it knows where the concentric and eccentric phases start.

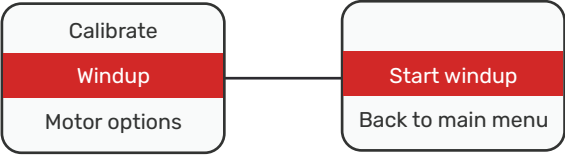

Windup

Start the Windup of the motor, it will wind in the rope. This is optional and the motorized boost will still work if the motor is enabled.

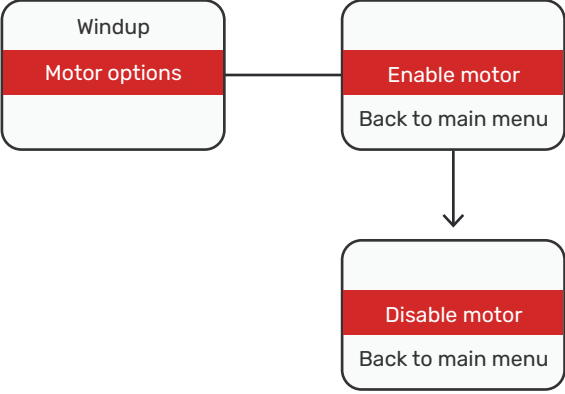

Motor Options

Enable the motor, so the motor will work. Disable the motor to prevent the motor working.

Attaching the wheels

The Ultimate comes fully assembled and ready to use, except for the wheels which can be added on if needed. The two wheels should be added to the side opposite to the shaft. This will make it the easiest to lift the other end and move the Ultimate around.

- 1 Turn the Ultimate upside down.



- 2 Using the supplied tools (a cross head screwdriver and a hex head screwdriver) use the 4 bolts and nuts to fix the wheel to the 4 bolt holes. The cross head screw driver is really only used to hold the bolt head from turning, as it will be much easier to turn the nut given the tight space.



Attaching the extension

For very tall users or to increase the range of exercises to include exercises such as sumo squats, an optional extension is available for purchase. The extension can be fixed on to the end of the Ultimate using 4 wing bolts.

- 1 Bring the extension close to the short side of the Ultimate.



- 2 Reach in through the open slot and screw in the 4 wing screws in each of the 4 holes to secure the extension to the Ultimate.



Enabling / disabling the motor

If your Exerfly Ultimate came with motorized technology, it includes a clutch to engage and disengage the motor. This mechanism is controlled by a red lever underneath, at the back of the Ultimate. This is useful for different modes of training. For performance athletes, the motor can be easily selected. Likewise, for beginners, elderly, rehabilitation and most other people, the motor can be easily disengaged.

1

Move the lever forward and the motor is engaged.



2

Move the lever backwards and the motor is disengaged.



There are sound queues which serve as a check that the motor is able to be used.

If you hear 3 beeps when trying to use the motor, this indicates that the motor can't be used because of one or more of these conditions below.

- a. The emergency stop button has been pushed (shows a green light on the button). Twist the button to release.
- b. The clutch lever has not been pushed forward.
- c. The motor has not been enabled in the app or on the console. Press the 'Enable Motor' button (app), or select the menu item (console).

Once you've resolved these 3 conditions, you'll hear a 'Zoom' sound, and that indicates the motor can now be used.

Note: If you still hear the 3 beeps after checking these 3 conditions, move the flywheel around one rotation to make sure the clutch mechanism has engaged.

Reminder: Remember, the motor boost resets to 0% after 5 minutes of inactivity, for safety reasons. Change the boost % in the app or console menu to start again.

Reminder: After turning on the Ultimate, extend the rope out all the way so it's vertical, and press the 'Calibrate' button.

Device holder

Device holder

A flexible pole that holds the user's device at any desired level. This allows you to control the app during your workout. To browse our selection of tablets online, scan the QR code below.



[exerflysport.com](https://www.exerflysport.com)

Attaching the device holder

- 1 Remove the plastic cap on the corner of the Ultimate and insert the device holder as shown. The device holder screws in.



Accessories

Squat harness

The Exerfly squat harness gives users the confidence to approach squats with ease. The Exerfly squat harness spreads the load across the shoulders and lower back so it's much more comfortable to use.



Squat Harness
Example Video



SCAN ME

If you need a different sized harness, please reach out to us at: sales@exerflysport.com

Curl bar

The curl bar is used for arm exercises like bicep curls, high pulls and dead lifts. Grip areas angled for optimal comfort when performing exercises.



Curl Bar
Example Video:



SCAN ME

Foot block

Enables users to do lateral leg exercises for those sports which require change of direction. Also useful for glute activation and elevation of the foot for calf raises.



Foot Block
Example Video:



SCAN ME

Accessories

Rope guide

Allows users to do horizontal exercises like rowing, rotational exercises and hip exercises. When using, position the rope guide close enough to where the rope comes out to avoid wearing down the protective rubber.

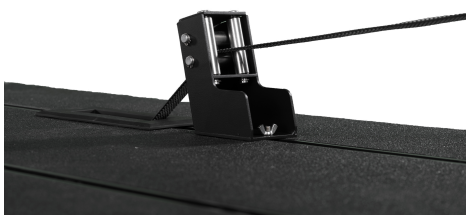

Rope Guide
Example Video:



Bench

The bench is useful for users to steady themselves for exercises, or to sit when doing calf raises. The bench can attach parallel or perpendicular to the Ultimate.



Exerfly Bench
Example Video:



T-Bar

The T-bar is useful when a user wants to hold on to something when doing exercises like lunges.



Additional accessories

Scan the QR below and visit the website to view our full range of accessories.

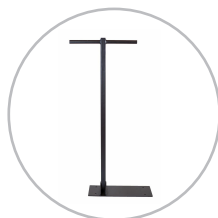
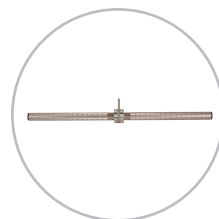

Further accessories such as tablets and carry cases are available from our online shop. To browse our selection of these and other accessories, please scan the QR below.



exerflysport.com



Troubleshooting

Q. The Exerfly Ultimate jumps when I perform squats.

A. You can place weights, kettle bells or someone else on the Ultimate to stop it jumping when performing the squat. Alternatively you can use tie downs to anchor it from underneath to floor anchors if they're available.

Q. How do I change the rope?

A. Please see this tutorial. You can also use the other end of the rope if part of it becomes frayed.

Replace rope
how-to video:



Q. Why can't I connect to the app?

A. Please see the App and Sensor Guide. But briefly, make sure you have Bluetooth enabled and also location enabled for the app.

Q. The motor won't engage.

A. Check the emergency stop button is not pressed down. Twist to release it. Make sure 'Enable Motor' has been selected. Check the motor boost % is not zero.



For any questions about the app or the equipment, please get in touch with us at: support@exerflysport.com



Or make an appointment via Calendly:
<https://calendly.com/exerfly-support/15min>

Maintenance

Bearings

These are ceramic bearings so require little maintenance but a spray of WD-40/CRC or similar every 6 months can help with smooth running.

Rope / webbing

The rope is very strong and wear resistant, but over a long period of time you may see wear and tear. To replace the rope, follow the QR link to the video tutorial.

Replace Rope
Example Video



Rope clamp

If after repeated use the rope clamp doesn't grip as much, use a few drops of acetone on the rubber surface to restore it.

Warranty

Exceptions

Parts through normal wear and tear such as belts, webbing, non-slip surface and other parts subject to wear. Defects in coatings. Additionally, where the customer has misused or abused the product, repair or service was not done in accordance with Exerfly Sport instructions, OEM products were not used, use of the product continued after the defect was first noticed.

Support

Exerfly Sport technicians will attempt to rectify the defect by any methods available, such as Phone, Email, Instant Messaging, video, service center and if needed, will ship a replacement or replacement part, subject to availability within a reasonable time after the buyer has contacted Exerfly Sport.

Transportation

Customer will ship or bring the product to/from a local service center at their expense and risk.

Limitations of liability

The customer is not entitled to compensation for personal injury or property damage.



2 Years

Warranty from the date of purchase.



30 Days

Money-back guarantee



Free

Shipping and taxes

Statement of compliance

Exerfly Sport Limited hereby confirms that the following product manufactured by Exerfly Sport Limited are in compliance with EU Directives.

2014/53/EU on Radio Equipment

2014/30/EU on electromagnetic compatibility

2011/65/EU on Restriction of hazardous substances in electrical and electronic equipment

2014/35/EU on Low Voltage

2006/42/EC on Machinery

Description of goods:

Exerfly Platform

Exerfly Platform with motor option

Exerfly Ultimate

Exerfly Ultimate with motor option

Exerfly Portable

Exerfly Rack-Fly

Exerfly Rack-Fly with motor option

All Exerfly Accessories.



Exerfly Sport Limited,

Unit 3, 4 Lake Bryndwr Lane, Christchurch 8053, New Zealand.

And, 2020 Prairie Lane, Eau Claire, Wisconsin 54703, USA.